

## Timing Belt and Cover Figure 8

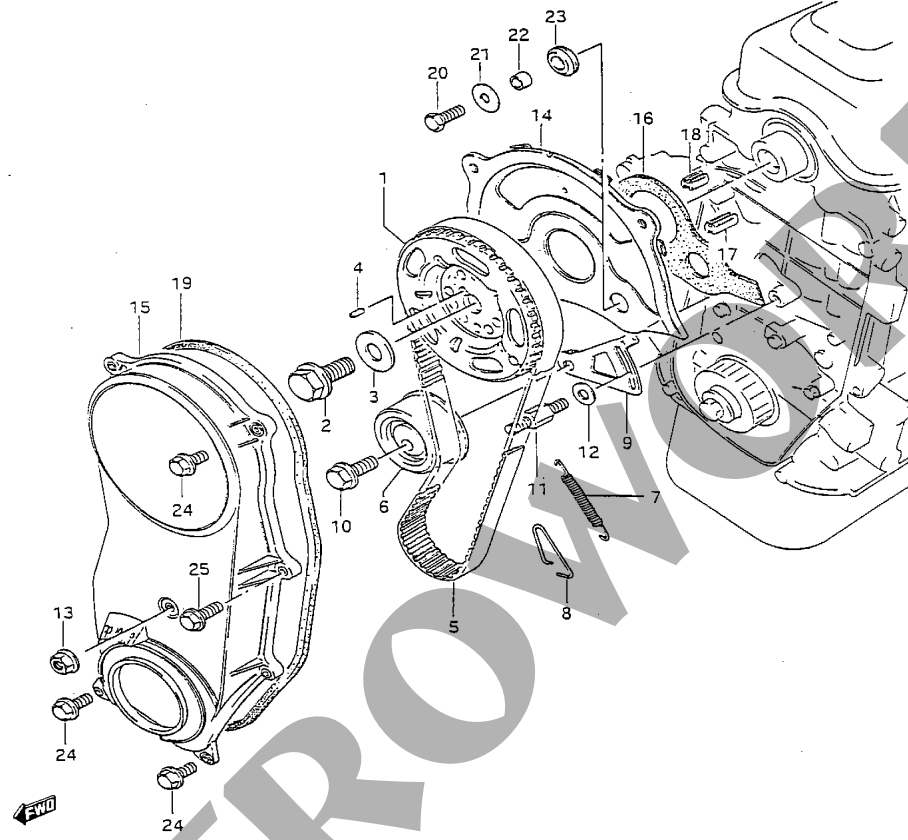

SAMURAI E33

Did you know?

**The Samurai engine is a noninterference engine. Unlike some vehicles, a broken timing belt will not cause engine damage. If you don't know when your timing belt was last replaced, carry a spare. It is not difficult to replace in the field.**

**The factory recommended maintenance interval for the timing belt is to initially inspect it for wear at 48 months or 60,000 miles after replacement, then re-inspect every 24 months or 30,000 miles from that point forward.**